



James Street, Whickham, Tyne And Wear, NE16 4AW

*****AVAILABLE MID FEBRUARY***** Lovely recently refurbished two bedroom terrace in the popular village of Whickham. The property is available from middle of February on an unfurnished basis and comprises of entrance porch, open plan lounge/kitchen, utility and bathroom to the ground floor. To the first floor are two double bedrooms and an en-suite W/C. Externally is a small rear yard with parking available on street. Viewing highly recommended. EPC rating D.



*****AVAILABLE MID FEBRUARY*****

Two Bedroom Terrace

Unfurnished

En-suite W/C

Holding Deposit £155

EPC Rating D

£675 per month

Open Plan Lounge/Kitchen 22' 1" x 15' 4" (6.73m x 4.68m) *max*

Kitchen area fitted with a range of wall and base units, integrated oven/hob.

Utility room 6' 11" x 3' 10" (2.11m x 1.18m)

Space for washing machine and fridge/freezer (not included).
Gas fired combi boiler.

Bathroom 6' 11" x 6' 0" (2.11m x 1.84m) *max*

Bath with shower over, wash basin, W/C, storage cupboard.

Bedroom 1 15' 6" x 10' 8" (4.72m x 3.25m) *max*

Fitted wardrobes.

Bedroom 2 11' 8" x 11' 3" (3.56m x 3.42m) *max*

En-suite W/C 4' 0" x 2' 4" (1.23m x 0.70m)

Wash basin, W/C.

Externally

Small yard to rear. Parking available on street.

Additional information

Council tax band A. Minimum tenancy length 6 months.

Holding deposit

This holding deposit secures the property for you while we conduct your reference checks and goes towards your first months rent prior to move in. It is not an additional fee.

EPC Graph (full EPC available on request)

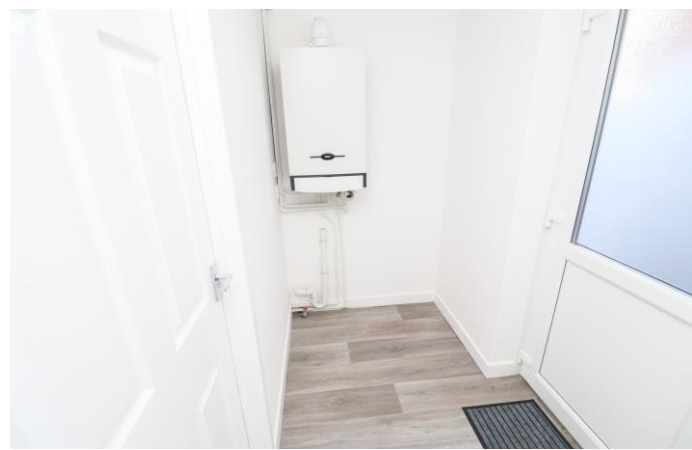
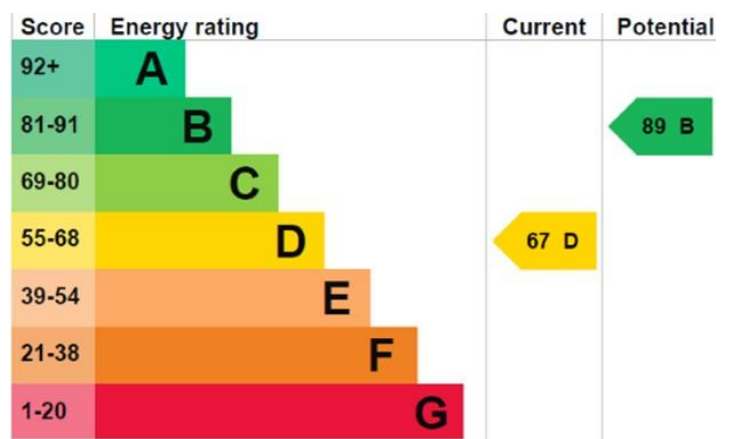

Floorplan

Ground Floor

Approx. 38.4 sq. metres (413.2 sq. feet)



First Floor

Approx. 31.6 sq. metres (340.4 sq. feet)

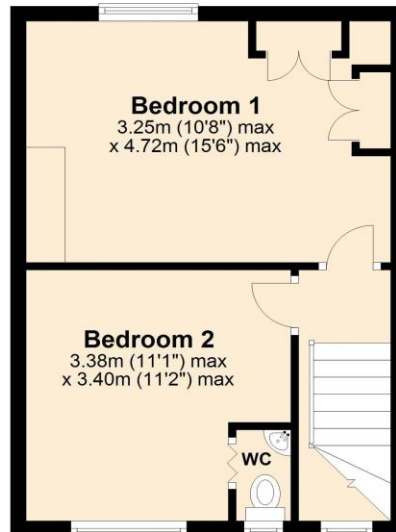

Total area: approx. 70.0 sq. metres (753.7 sq. feet)

For more information please call **0191 414 1200** or email info@livinglocalhomes.co.uk

WE WIN AWARDS year-after-year and are currently ranked in the top 5% for lettings in the country!

Lorraine Valuer & Negotiator

Emma Owner & Managing Director

Laura
Sales & Lettings Negotiator

Brooke
Lettings
Co-ordinator

Louise
Sales & Lettings Negotiator



facebook

PRS
Property
Redress
Scheme

rightmove

onTheMarket.com

Zoopla.co.uk

PrimeLocation.com

firstmortgage.co.uk®

